

System No - W-J-3136

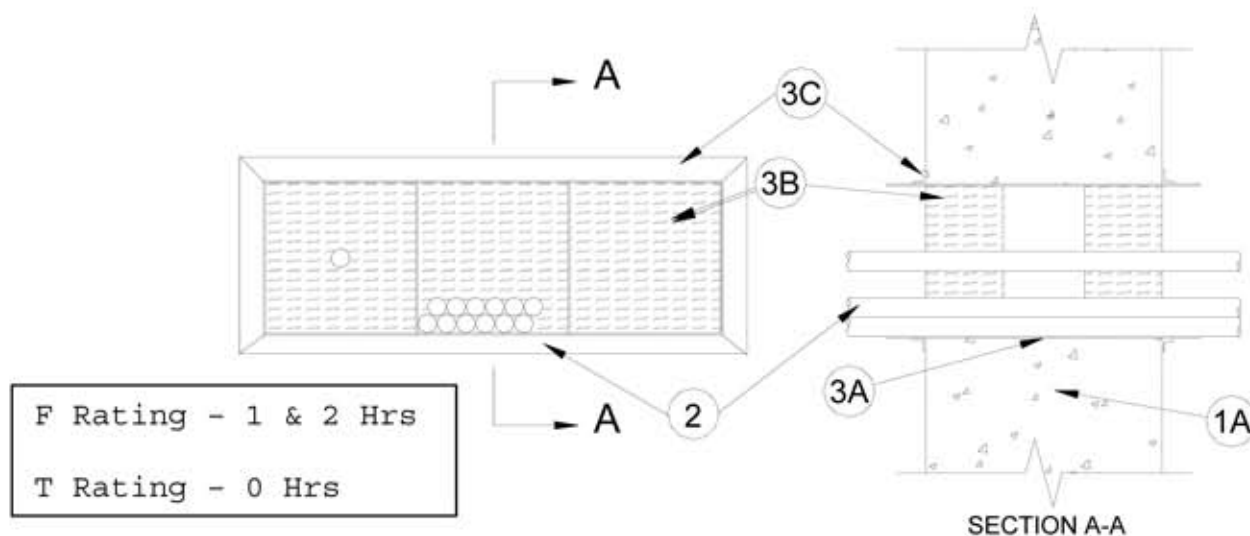

1. **Wall Assembly** - Min 4-7/8 in. or 6-1/8 in. thick lightweight or normal weight (100-150 pcf) concrete for 1 and 2 hr rated assemblies, respectively. Wall may also be constructed of any UL Classified Concrete Blocks*. Max dimensions of opening are 12 in. by 4 in.

See **Concrete Blocks** (CAZT) category in the UL Fire Resistance Directory for names of manufacturers.

2. **Cables** - Aggregate cross-sectional area of cables in opening of firestop device (see item 3A) to be max 20 percent of the aggregate cross-sectional area of each device opening within the firestop device bank. Cables to be installed either concentrically or eccentrically within the device openings. The annular space shall be min 0 in. (point contact) to max 3 in. Cables to be rigidly supported on both sides of wall assembly. Any combination of the following types and sizes of cables may be used:

- A. Max 12/C No. 18 AWG (or smaller) cable with PVC insulation and jacket.
- B. Max 3/C No. 12 AWG (or smaller) with PVC insulation and jacket.
- C. Max 4 pair No. 24 AWG (or smaller) data cable with PVC insulation and jacket.
- D. Max 3 pair No. 2 AWG (or smaller) with PVC jacket and insulation.

3. **Firestop System** - The firestop system shall consist of the following:

- A. **Firestop Device*** - Max three galvanized steel cable transits interior-lined with an intumescent material fitted side by side and sized to fit specific size of the opening installed in accordance with accompanying installation instructions.

ABESCO LTD - CT120 Transit

B. **Packing Material** - Min 2 in. thickness of nom 4.0 pcf mineral wool batt insulation firmly packed into the annulus between the cables and the transit flush with both surfaces of wall.

C. **CT Mounting Flange** - CT Mounting flange factory fabricated from min 5/8 in. by 5/8 in. min 20 gauge galv steel. CT Mounting Flange to be secured around the Firestop device on both sides of the wall by friction fitting using nut and bolt provided with flange.

*Bearing the UL Classification Mark